

PERFORMANCE:

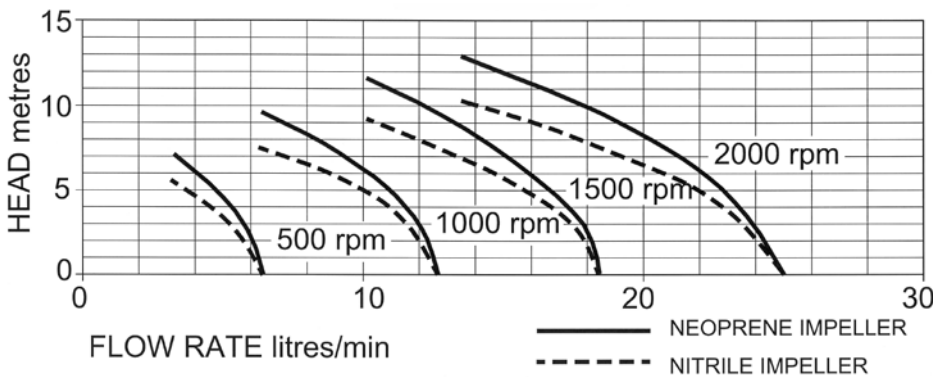

MODEL	Maximum flow rate		Maximum head	
	l/min	gall/min	metres	feet
6540-200	25	5.5	13	43
6540-237	25	5.5	10	33

DIMENSIONS:

WEIGHT: 0.91Kg

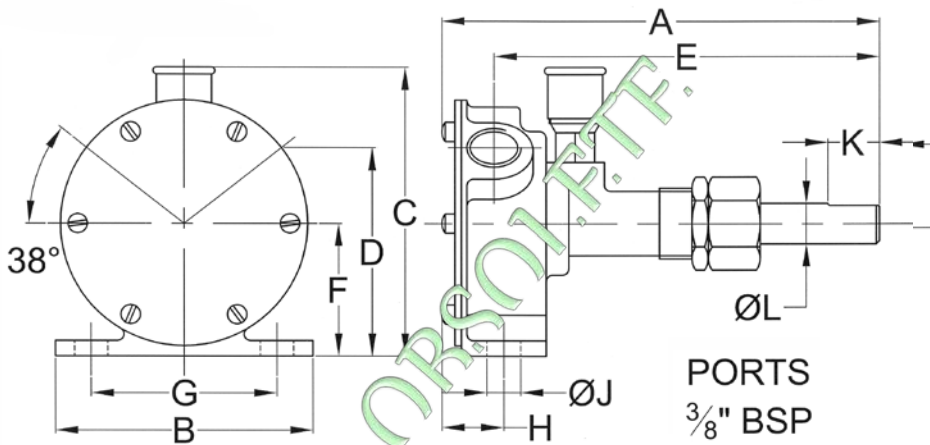

A	B	C	D	E	F	G	H	J	K	L
135	79	90	65	119	41	57	19	Ø10	16	Ø12.6

MATERIALS OF CONSTRUCTION:

Body	Bronze
Impeller	Neoprene or Nitrile
Shaft	Stainless steel
Shaft seal	Packed gland type
Bearings	Plain
Port type	3/8" BSP to BS21 (DIN2999)

MODELS:

- 6540-200** Standard Neoprene Impeller
- 6540-237** Oil resistant Nitrile



BRONZE FLEXIBLE IMPELLER PEDESTAL PUMP

6540 SERIES



PUMP with 3/8" BSP PORTS

- * Constructed from marine quality bronze and stainless steel
- * Self-prime from dry up to 1.5m
- * Easy to service and maintain
- * Will tolerate abrasive wear
- * Handles hard and soft solids without clogging
- * Can pump in either direction
- * Will not airlock